

an **architectural design** competition team submission
for a \$200 million museum in Giza near the Pyramids

in which first-round competitors
were limited to five 11x17 sheets
basically a **marketing presentation**
to attract jurors to our solution
among thousands of entrants
—thus each sheet designed as a ‘**poster page**’
to quickly and clearly market our team’s concepts

one poster shows views of a **virtual model**
of our five-person design-team’s entry

challenged by the competition program
to chronologically display
up to 150,000 artifacts
from Cairo’s Great Egyptian Museum

we designed along a spiral building path
the assigned **historical** series of galleries
—and then used allowed general galleries
for more **recent**-history displays
and **current**-situation displays
leading up to a participatory gallery
of **future** visions for the country

other design elements capture natural light,
align with solar events,
maximize natural energy,
offer dramatic views of the Pyramids
and include a prayer chamber facing Mecca

architecture + spirituality
 a symbolic expressive organic sculpture
curvilinear juxtaposition to the geometric Pyramids, still aligned with the Heavens and intended
for the Ages, while enveloping those visiting this ‘jewel of nine charms’ with emotional wonder

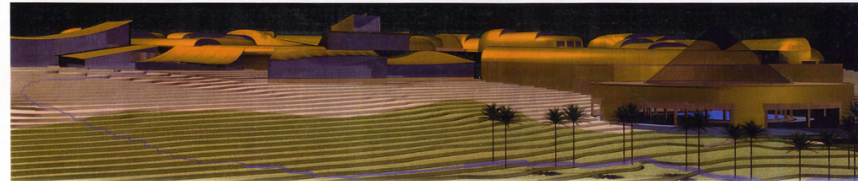

entrance approach from Cairo-Alexander Road overpass—archaeological digs, Abu Simbel re-creation to the right, scaled Nile simulation and Pyramid-facing restaurant to the left—a gold jewel amidst the ‘Sands of Time’, green gardens within



the spiraling GEM symbol, pointing south—identified with the neighboring Pyramids, reflecting the Sun’s light in the desert—its expression of the long-evolving Story of Egypt seared in the minds of visitors near and far, in atoms and bits

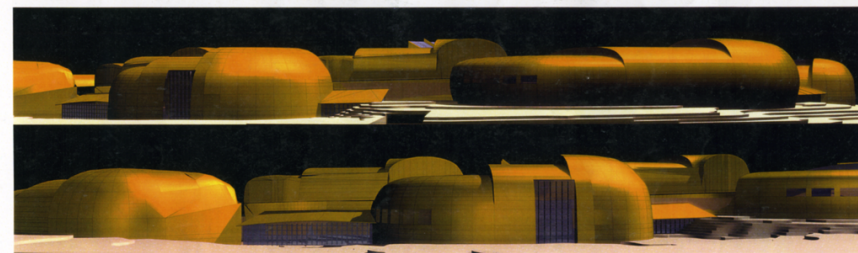

adjoining views from the south—galleries wrapping around the spiraling ‘spinal’ path, each shaped to avoid the Sun’s heat and sandstorms, while aligning with its positions and gathering its reflected north light—intended for the Ages

stroll inside or out, every visit will sear your memory yet be
unique on your return—whether physical or virtual—whether
tourist or local, staff or public, lingering or moving through

panel C